

INTERLOCKING CABINET WCI-4808-36

The Teclab Interlocking Storage Cabinet. Setting a new standard in storage!

That’s exactly what you’ll be thinking when you take a good look at the new Teclab Interlocking storage cabinet. The Teclab design team has redefined the storage cabinet with Teclab’s industry leading standard of quality and durability.

The Interlocking Storage cabinet features beefier construction with heavier material than competitive cabinets. With exclusive Teclab features including rugged internal frames, reinforced drawers with smooth operating slide mechanisms, easy to use four-point in-cabinet leveling and our Teclab 10-year warranty.



TOP

WCI-4808-36 FEATURES

Three Interlocking “A” Drawers

Drawer Face Dimensions: 34 ½” wide, 4” high, 1” thick.
 Drawer Body Inside Dimensions: 32” wide, 3” high, 24” deep.
 Weight Capacity: 180 lbs. each.

Two Interlocking “B” Drawers

Drawer Face Dimensions: 34 ½” wide, 6” high, 1” thick.
 Drawer Body Inside Dimensions: 32” wide, 5” high, 24” deep.
 Weight Capacity: 180 lbs. each.

Double Locking “C” Doors

Door Face Dimensions: 17 ¼” wide, 16 ⅜” high, 1” thick.
 Sliding Tray Dimensions: 32” wide, 4” high, 24” deep.
 Weight Capacity: 180 lbs. each.

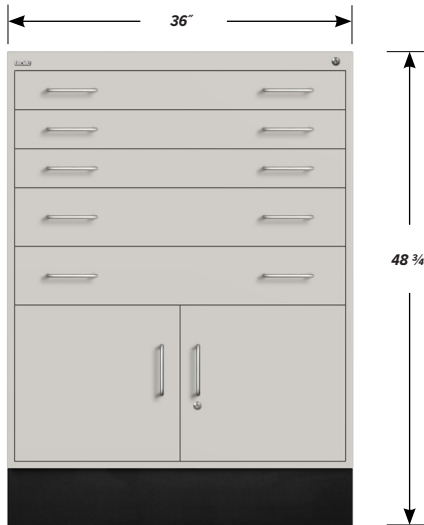

FRONT

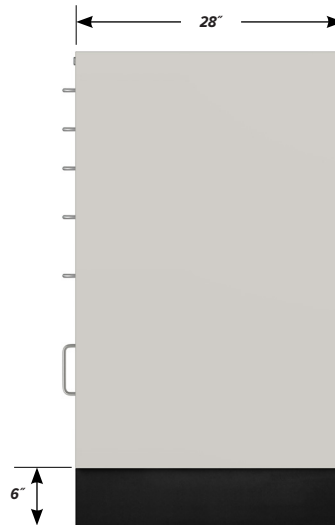

SIDE