

WALL CABINET SPACERS

Teclab Wall Cabinet Spacers allow a run of Wall Cabinets to fill a room wall-to-wall.

Spacers can be made in any width to fill gaps between cabinets or between a cabinet and a wall.

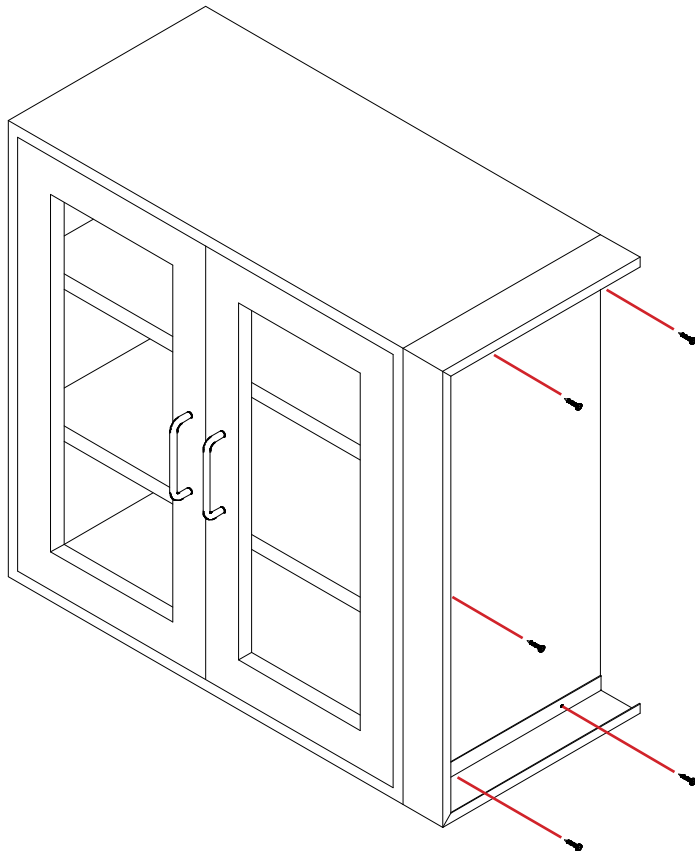
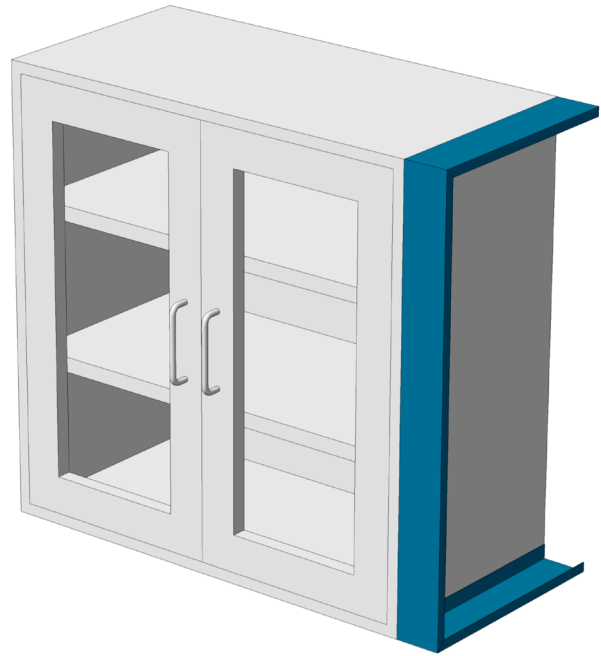

INSTALLATION

The spacer has pre-drilled holes.

Attach the spacer to the cabinet using the included self-drilling screws.

The double wall cabinet construction will conceal the screws on the interior.

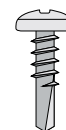

self-drilling
screw